

# ARCOLA BUS SALES

A Div. of Arcola Sales & Service Corp.

51 Kero Road

Carlstadt, N.J. 07072-2601

Tel: (201) 507-8500 Fax: (201) 507-5372

www.ArcolaSales.com

\*\*\*\*\*  
\*\*\*\*\* **VEHICLE SPEC** \*\*\*\*\*  
\*\*\*\*\*

Date: 03/07/10

Ref No.: 31908-STK000-HS

## CONFIGURED FOR:

*Middlesex Regional Ed. Serv. Comm.*

## VEHICLE TYPE:

New/Used: N  
Year: 2011  
Body Manuf: Collins  
Chassis: Chevrolet

Item 3 - Optional 29 Passenger W/ 14,200 G.V.W.R.  
D.R.W Collins Grand Bantam  
159"Wb 6.0ltr Gas Eng. 14200gvwr

## DETAILED DESCRIPTION:

| Item                                    | Qn | Fleet Price |
|-----------------------------------------|----|-------------|
| STOCK # 31767                           | 1  | 0.00        |
| * COMPETITIVE ALLOWANCE                 | 1  | 0.00        |
| BASE ITEM #3                            | 1  | 43,270.00   |
| CORE CHEV GRAND 6SEC 09                 | 1  | 1,452.00    |
| PRICE ADJ LEVEL2 CGX6                   | 1  | 0.00        |
| CHEV DRW159 6.0G AC Y 14.2 2010         | 1  | 2,004.00    |
| GM GOVT PRICE CONCESSION                | 1  | 0.00        |
| * FREIGHT FROM KS                       | 1  | 0.00        |
| AC 45K INWALL ACT CHEVY CS2             | 1  | 197.00      |
| RADIO AM/FM/CD 4SPK CHEV                | 1  | 292.00      |
| BUMPER 10" DRW EXH UNDER/SIDE           | 1  | 0.00        |
| ENDCAPS GX FGLASS COL WARN LT           | 1  | 0.00        |
| RUBRAIL SEAT LEVEL DRIVER DR            | 1  | 75.00       |
| RUBRAILS FLOOR LEVEL GX6                | 1  | 0.00        |
| RUBRAILS SEAT LEVEL GX6                 | 1  | 0.00        |
| RUBRAILS SKIRT GX6 AC                   | 1  | 0.00        |
| MUD FLAPS REAR GX                       | 1  | 35.00       |
| TOW HOOKS REAR                          | 1  | 23.00       |
| * UNDERCOAT - FULL UNDERBODY N.J.       | 1  | 0.00        |
| EXHAUST CHEV X6 UNDER/THRU              | 1  | 0.00        |
| EXHAUST FLUSH W\BUMPER OR SIDE          | 1  | 15.00       |
| GM TILT ONLY (9J6)                      | 1  | 193.00      |
| DOOR CONTROL MANUAL, 12 SWITCH MAX S/GX | 1  | 37.00       |
| DOOR ENTR GLASS TEMP H/S/GX             | 1  | 0.00        |
| GRABRAIL LH ENTR 42IN BARR MNT          | 1  | 0.00        |
| GRABRAIL RH ENTR 30IN                   | 1  | 0.00        |
| DOOR REAR EGRESS RHHINGE SX/GX          | 1  | 0.00        |
| REAR DOOR HINGE 1PC STAINLESS           | 1  | 0.00        |

| Item                                              | Qn | Fleet Price |
|---------------------------------------------------|----|-------------|
| REAR DOOR LATCH 1PT                               | 1  | 0.00        |
| VANDAL LOCK REAR DOOR W/BUZZER                    | 1  | 95.00       |
| WNDW REAR DOOR LOWER TEMP CLR                     | 1  | 0.00        |
| WNDW REAR DOOR UPPER TEMP CLR                     | 1  | 0.00        |
| CIRCUIT BRKRS IN LIEU OF FUSES                    | 1  | 117.00      |
| BATTERY NO BOX CHEV GAS                           | 1  | 0.00        |
| FLOOR COVER BLK OFFSET GX6                        | 1  | 0.00        |
| STEP TREAD GX RIBBD BLK/WHT                       | 1  | 0.00        |
| SUBFLOOR GX6 5/8 PLY MARINE                       | 1  | 77.00       |
| HEATER 50K FLR MOUNT CHEV                         | 1  | 0.00        |
| HEATER SHUT OFF VALVE-CABLE OP                    | 1  | 0.00        |
| INT PANELS LOWER EMB GALV X6                      | 1  | 0.00        |
| INT PANELS UPPER GX6 SMOOTH                       | 1  | 0.00        |
| PADDING PKG GX GRY FB                             | 1  | 0.00        |
| DOME LTS THRU IGNITION                            | 1  | 0.00        |
| MONITOR 16LT LED WARN LIGHTS                      | 1  | 162.00      |
| PAINTED BLACK BORDER WARN LT                      | 1  | 0.00        |
| STROBE PREWIRE 1FT FROM REAR                      | 1  | 53.00       |
| VISORS 8LT                                        | 1  | 0.00        |
| WARN SYS 8LT MSTR/FT-WARN/CNCL                    | 1  | 41.00       |
| WARNING LAMPS 8LT HALOGEN SURF                    | 1  | 0.00        |
| CLEARANCE LIGHTS LED - LOW PROFILE                | 1  | 0.00        |
| REVERSE LED WITH REAR DR OPEN                     | 1  | 0.00        |
| STOP/TAIL 7IN RED                                 | 1  | 0.00        |
| STOP/TAIL/TURN 4IN FLUSH                          | 1  | 0.00        |
| TURN SIGNAL MIDBODY AMB FLUSH                     | 1  | 0.00        |
| TURN SIGNAL REAR 7IN AMBER                        | 1  | 0.00        |
| STORAGE COMP LINER GX 22x22x16                    | 1  | 53.00       |
| MIRROR INTERIOR 6X16 FLAT                         | 1  | 0.00        |
| MIRRORS, HEAT/RMT REAR & HEAT CROSS - ROSCO CS/CG | 1  | 688.00      |
| PAINT BODY EXT CHEV SX/GX YELL                    | 1  | 0.00        |
| PAINT ROOF WHITE                                  | 1  | 0.00        |
| PAINT RUBRAILS NJ STYLE BLACK                     | 1  | 0.00        |
| INFO LABEL NJ CHAS MFG/PAS CAP                    | 1  | 0.00        |
| LTRG/EMERG DR ARROW RED                           | 1  | 0.00        |
| EGRESS WINDOW SIGNAGE FMVSS/Y                     | 2  | 0.00        |
| BARRIER HB LH 45 MED GRAY FB                      | 1  | 0.00        |
| BARRIER HB RH 30 MED GRAY FB                      | 1  | 0.00        |
| * BACK-UP ALARM                                   | 1  | 0.00        |
| BODY FLUID KIT #200-902 MULTI                     | 1  | 25.00       |
| CHILD ALERT CHILD-CHECKMATE                       | 1  | 237.00      |
| WRECKING BAR 30IN                                 | 1  | 0.00        |
| STOP ARM INCND TS REFL 6000                       | 1  | 0.00        |
| HATCH TRAN 1975-004-111 1IN Y                     | 2  | 0.00        |
| CROSS ARM CHEV SPEC 68600 POLY                    | 1  | 0.00        |
| HOLDER MAGNET CROSS ARM #8100                     | 1  | 100.00      |
| ENDCAP "SCHOOL BUS" REFLECTIVE                    | 1  | 0.00        |
| * INSTALL SEAT TO FLOOR BOLT/NUT                  | 12 | 0.00        |
| SEAT HB LH 45 ASY MED GRAY FB                     | 4  | 0.00        |
| SEAT HB LH 45 ASY MED GRAY FB                     | 1  | 348.00      |
| SEAT HB LH 30 ASY MED GRAY FB                     | 1  | 0.00        |
| SEAT HB RH 30 ASY MED GRAY FB                     | 5  | 0.00        |
| SEAT HB RH 30 ASY MED GRAY FB                     | 1  | 290.00      |
| SEAT BELT 60IN BLACK CBC                          | 12 | 0.00        |
| SEAT BELT 60IN GRAY CBC                           | 12 | 0.00        |
| SEAT BELT 60IN RED CBC                            | 5  | 0.00        |



290.37  
BUMPER TO BUMPER

SEATING CONFIGURATION BASED ON ENGINEERING ESTIMATES. FINISH BUILT BUS WEIGHTS MAY REQUIRE REDUCTION IN CAPACITY.

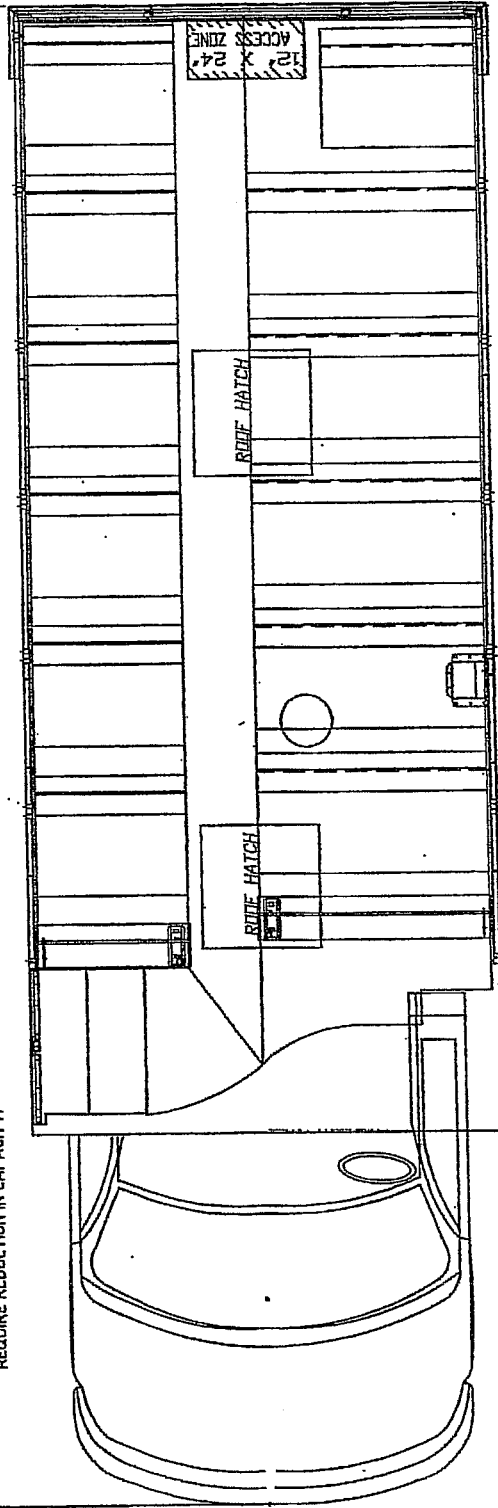

CGX6

29 Passengers  
6 30 inch RH Seats at 25 inch Hip to Knee  
5 45 inch & 1 30 inch LH Seats at 24 inch Hip to Knee



TITLE CHEVY GRAND SB

COLLINS BUS CORP.  
P.O. BOX 2946  
HUTCHINSON, KS.  
67504-2946  
FORM F-7.3.06 REVISION 0

THIS DRAWING AND ALL INFORMATION THEREON IS THE PROPERTY OF COLLINS IND. INC.

|             |                 |
|-------------|-----------------|
| DRAWING BY  | DEL             |
| DATE        | 02/03/09        |
| DRAWING No. | CGX6a 630 54530 |